



## 15 COTTERS LANE

*EAST BRUNSWICK, NJ*

# 42,052 SF

*Drive-times*

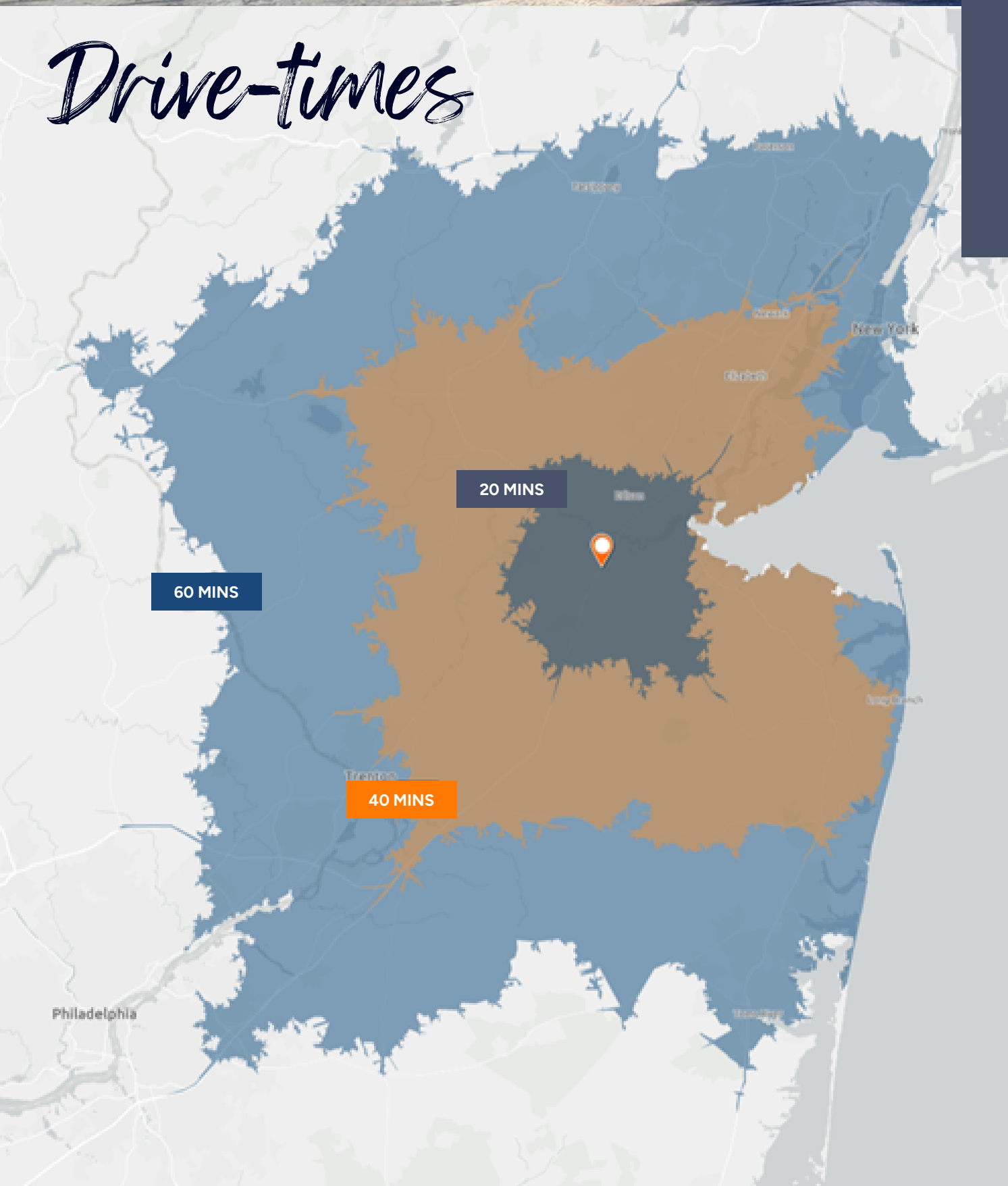

- 5,406 SF OFFICE
- 36,646 SF WAREHOUSE
- BUILT IN 1975
- SEVEN (7) TAILBOARDS
- TWO (2) DRIVE-INS
- 30' X 40' COLUMNS
- +/- 20' CLEAR HEIGHT
- .33/3,000 SPRINKLER SYSTEM
- 800 AMP, 240 V + 400 AMP, 480 V ELECTRICAL SERVICE
- FENCED TRUCK COURT



Site Plan

# 15 COTTERS LANE

EAST BRUNSWICK, NJ

COTTERS LANE

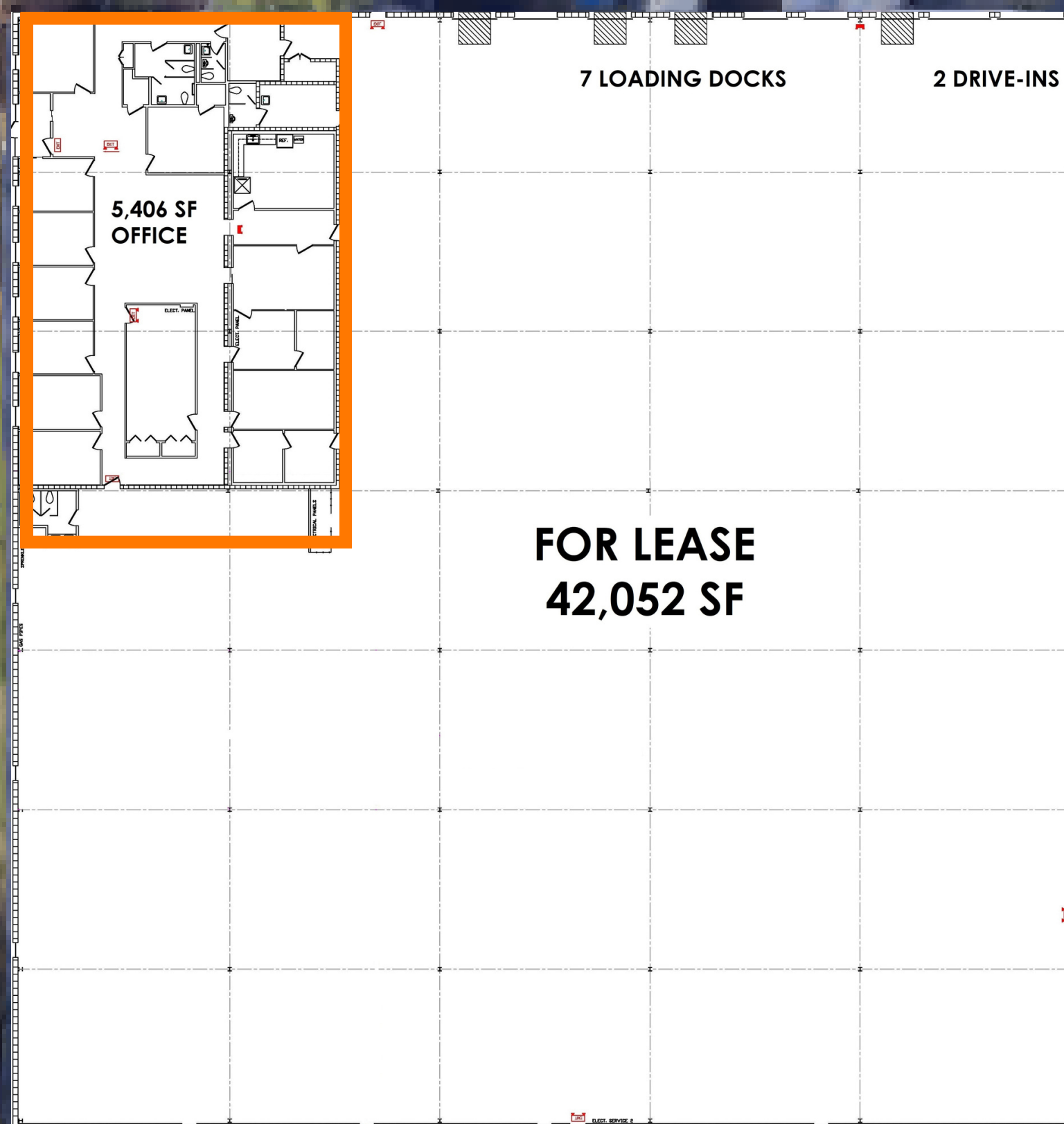
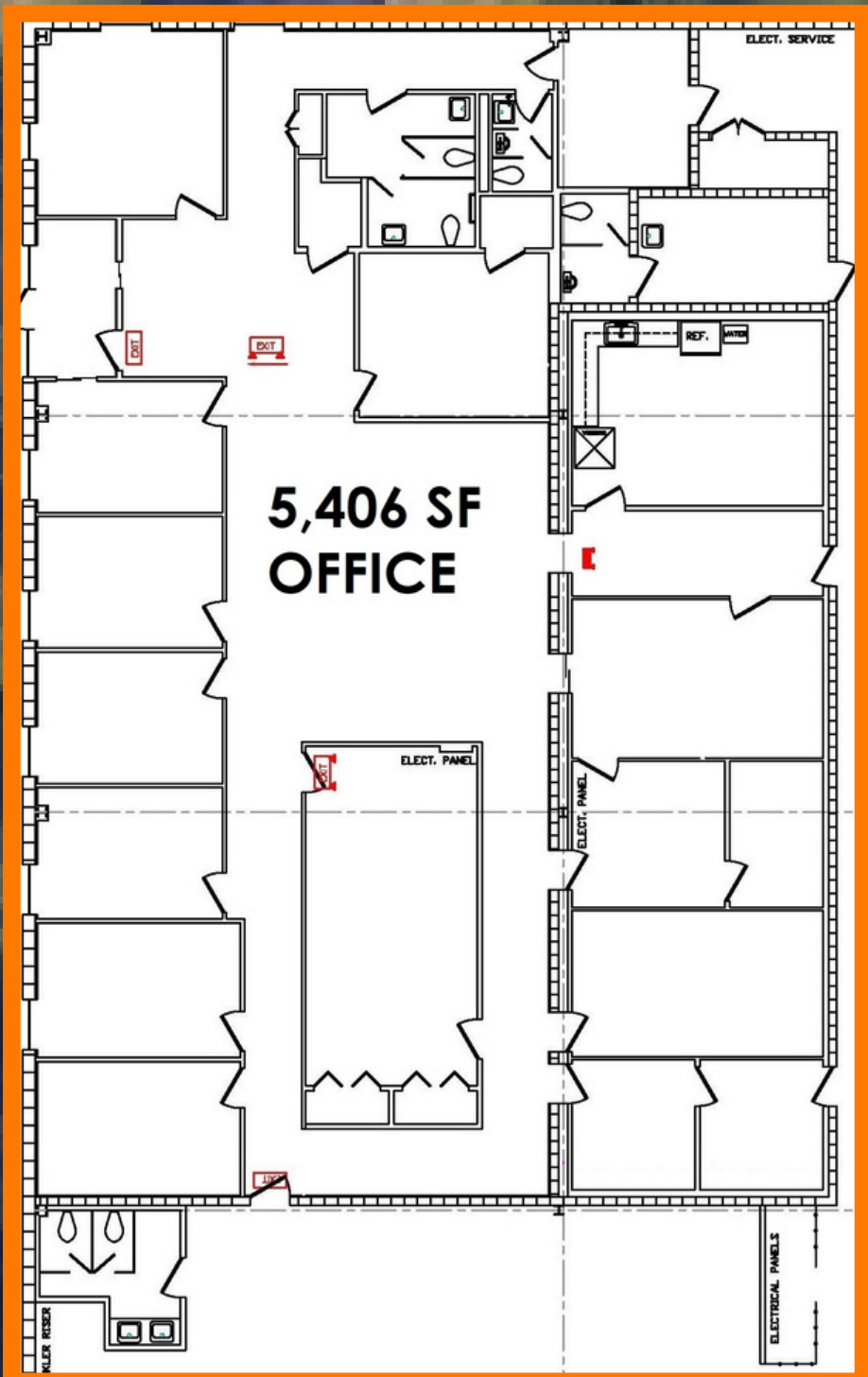

ELKINS ROAD

Area Map

# 15 COTTERS LANE

EAST BRUNSWICK, NJ



3D TOUR 

ROUTE 18: 1 MILE  
NJ TURNPIKE EXIT 9: 2 MILES  
ROUTE 1: 3 MILES  
NEWARK AIRPORT: 25 MILES

PORT OF NEWARK: 28 MILES  
NEW YORK CITY: 35 MILES  
PHILAPORT: 60 MILES  
PHILADELPHIA AIRPORT: 75 MILES

	10 MILE RADIUS	20 MILE RADIUS	30 MILE RADIUS
TOTAL POPULATION:	821,495	2,654,662	7,814,175
TOTAL LABOR FORCE:	666,595	2,148,380	6,331,877
TRANSPORT/WAREHOUSE WORKERS:	31,831	97,342	252,364
AVERAGE HOUSEHOLD INCOME:	\$158,629	\$172,005	\$160,708

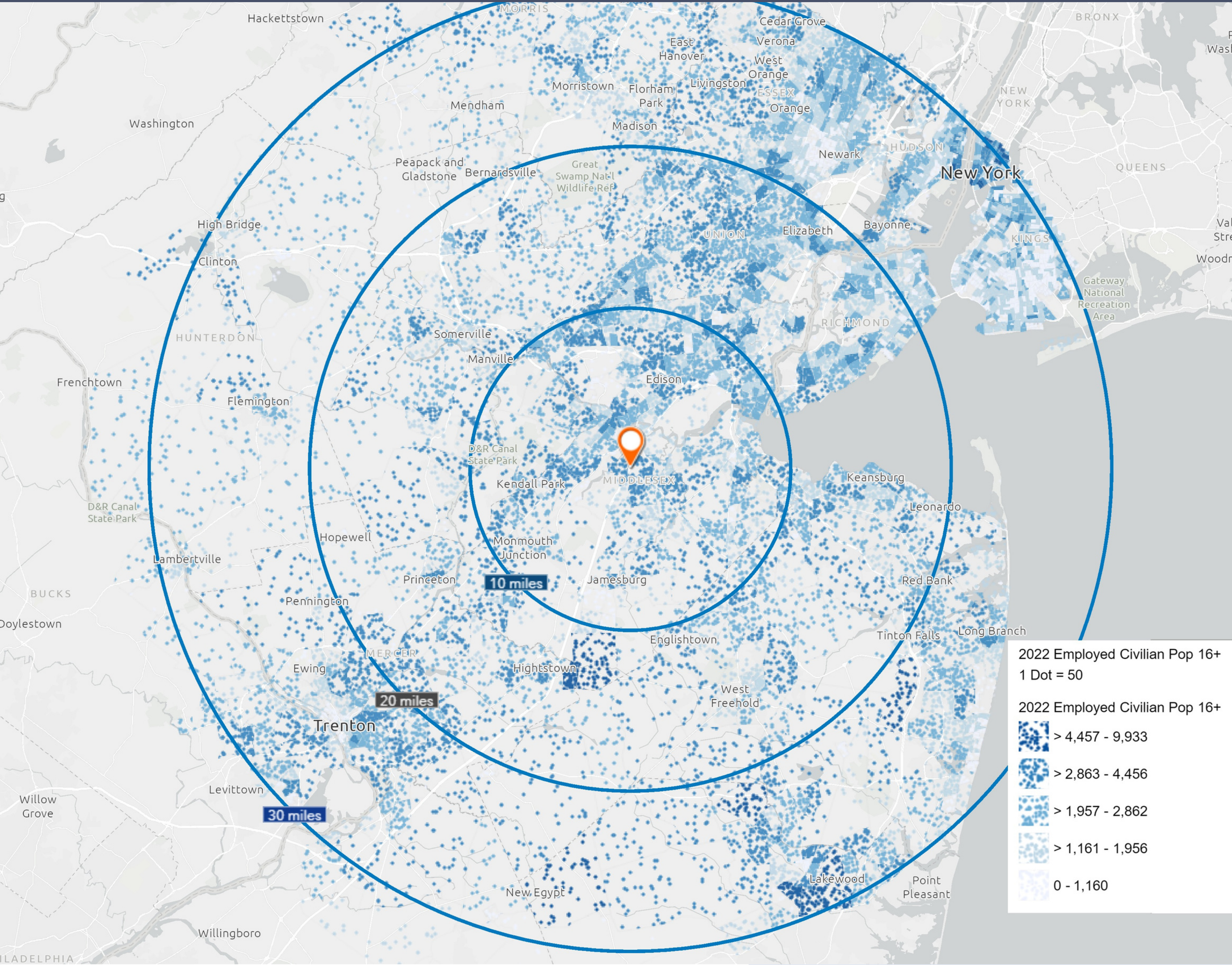

FOR MORE INFORMATION

JASON FISCH, BROKER | VICE PRESIDENT OF LEASING  
📞 732-258-3400 ✉️ JASON.FISCH@GREEKREP.COM

PATRICK REISTROM | LEASING ASSOCIATE  
📞 732-609-5829 ✉️ PATRICK.REISTROM@GREEKREP.COM



1 KIMBERLY ROAD, SUITE 105  
EAST BRUNSWICK, NJ 08816